



THE NEXT MEETING **October 27** AT  
**THE TABLE TENNIS CLUB**  
 1407 E HARRY

**VOLUME 17**

**ISSUE 10**

**Social Gathering @ 6:30 PM**  
**Meeting Starts @ 7:00 PM**

Subject	Page
<b>This Month's Meeting</b>	<b>1</b>
<b>President's Corner</b>	<b>1</b>
<b>Minutes</b>	<b>1</b>
<b>Sawmill Demonstration</b>	<b>3</b>
<b>Program Photos</b>	<b>3</b>
<b>Short Tip</b>	<b>5</b>

**Subject Of The Upcoming Meeting**

The use of biscuits to join wood glue joints, including the selection of size and material. Biscuits are designed to hold two boards being joined and will serve to hold the pieces so they match in height and are held level. Discussion of the use of biscuits in differing conditions and use of different joints will be discussed. The cutting of slots to utilize biscuits will be demonstrated as well. Garry Dougherty

**From The President's Corner –**

Presidents Newsletter - September

Fall is my favorite time of year, and I'm enjoying getting back in my shop and making a little sawdust. Please bring items you've made recently for show and tell. For example I know of one individual who is making a cello, and maybe we can persuade Les to bring some of his fine work. Lately Kenny Hill has brought some really nice pieces as many of you have. We

should see some fine projects since the weather has been so nice. You won't want to miss the October meeting.

I hope you made the Big Tool Store Fall sale held on October 23-25, 2008 where they gave 10% off all purchases, and 20% off name brand power tools. You might consider bringing some of your new tool acquisitions for show and tell. Exchanging ideas, about neat new tools you have acquired, always makes for interesting conversation. A couple of our members now have Saw Stop table saws, which were acquired prior to the sale.

At last months meeting we received hundreds of old copies of Wood and other periodical magazines from a man who had acquired them over his entire lifetime. Jack Pearson delivered them to us and attended our meeting. Bill Tumbleson has volunteered to place the magazines and periodicals in order by the month they were published so we can place them in our library when the new book case is completed. Thanks again to Bill for his volunteer efforts. Volunteer efforts are what make our Guild grow.

**Sunflower WWG meeting minutes  
 September 2008**

**Guests:** Marvin Francamp  
 John Tumbleson  
 Jack Pearson

Toy Program: The officers held a meeting to discuss the dates and locations for public display of the toys this year, as City Arts will not be hosting us this year. The tentative date Friday November 28th has been selected if all the planets are in alignment this year. This is the final Friday art crawl in the old town area.

Old Business: Refreshments by Gene for October, Ron Butts for November.

We are going to have a display at the Big Tool Store on Saturday the 25th, come by and help demonstrate something or just get to know the members better. The more the merrier.

Show and Tell: Jack Pearson showed an 8-foot pine decorative airplane propeller that he has a twin to at the Wichita air museum. Jack worked for Cessna aircraft before retiring. His replica even used copper leading edge protection.

Kenny Hill made a 1/3 scale model of a garden bench that his wife would like him to make the real thing!

Clark Schultz showed a few poplar stools that are for the toy program.

Jerry Keen brought in a walnut natural edged baseball bat holder for his grandkid.

Hay Hazelwood showed off his first attempt at oak finger jointed boxes, great job for a first timer!

Bill DeGarmo showed a small pine heart shaped stool for the toy program.

Larry Roth showed that he has learned something from being in the guild and having experience on his side. He brought in a bench that he built over 25 years ago and it looked pretty well worn. He used it as inspiration for an ash and cedar version that will last longer because he learned about wood movement and allowed the top to float.

Bill Tumbleson showed some toy trucks that he knocked out of 2x4 stock. He also brought in a

soft maple lap desk from plans in Wood Magazine.

Tom Foster passed around some safety glasses from 1919-1920 era that looked more like brazing goggles than safety glasses! Makes you appreciate polycarbonate glasses.

Les Hastings brought in a curved veneer panel and the lay-up form for his grand daughter's walnut slay bed crib that he needs to get done by early November. He lays up the veneer in the flat to thin bending plywood and then laminates it to the final substrate to eliminate veneer lifting on reverse bends.

Program: Les Hastings presented his experiences as carving to enhance woodworking. Les started carving about 16 years ago with no prior experience. He has always had an artistic side with sketching and drawing cartoons so the visualization of the finished carving is in his mind before he starts. His first piece was a western table for Sheldon Coleman that is in his Colorado home. Talk about a first project!! The second project was a relief carving of a basket of flowers in cherry. His motto is, "You don't know that you can't do it, if you don't try".

He is a self-taught carver that every time he carves, he tries something new. Every thing gets sketched out before taking a tool to wood. Using tracing paper, you place the paper over the blank wood and you can see thru the paper to orient the best layout. Rub the lead onto the wood and you have reference marks to carve to. Les likes to use a router whenever possible to waste away wood to quickly do most of the depth removal. His most used tools are the short palm cutters, the reciprocating Automach carver with Flextool blades and an angle Dotco sander for roughing. Les sharpens his tools with a belt sander followed by a quick deburr on a charged buffing wheel. Walnut, mahogany and soft-maple carve well; oak, ash and birch don't carve easily. Les let the members try their hand at carving on some sample woods.

Les would like to see the members push themselves to try something new because "You

don't know that you can't do it, if you don't try".

## Sawmill Demonstration

We met at the home of John Haskins at 9:00 a.m. on Saturday October 11 to observe his sawmill in operation. The weather was beautiful. There were 14 members and guests in attendance. He opened the demonstration with some pertinent information about the sawmill and it's operation, and entertained questions from the group. His explanations were very detailed and I think members came away with considerable knowledge regarding sawmill operations. He was very congenial and provided coffee, doughnuts, sweet rolls and water.

He had set up a white oak log about 20 inches in diameter and 8 foot long. He proceeded to take cuts off each side of the log and then cut 1 inch thick planks of lumber from it. The sawmill table had a device for turning the log and dogs to hold it in place while he made his cuts. The white oak log was being cut to obtain a 3 inch thick slab 12 inches wide and seven feet long for a client's fireplace mantel. What an interesting demonstration. I've seen several sawmills in operation, but this was by far the most informative and interesting demonstration I've witnessed. John also showed the group his lumber storage building which is chucked full of lumber. He indicated he would sell lumber if anyone is interested. John claims to have or have cut every wood species grown in Kansas.

What we learned about John's sawmill was it is a Log Master capable of sawing logs 36 inches in diameter and 21 feet long. The band saw used for cutting lumber was 2 inches wide, had 1 tooth per inch and was 19 feet in length. The engine which drives the hydraulic pump that powers the saw blade and all other parts of the sawmill is an 85 horsepower Cummings diesel.

As an added bonus John showed us the 40 foot sailing boat he is building from wood and fiberglass. He used mostly 3/4 inch plywood for

the hull. The interior trim will be entirely black walnut that he has cut.

.....

## September Meeting Pictures



Inspired by 2x4 challenge (Kenny Hill)



Lap desk by Bill Tumbleson



Simple cars for Toy Project



More Simple vehicles



Box project first box joints ( Hay Hazelwood)



Stool ( Clark Schultz)



Jack Pearson explaining propeller carving



Les showing Jack's propeller



Bending form and ends for baby bed by Less Hastings



More carvings



Carving Tools



More carving chisels



Carving Examples

## How To Handle a Scraper

There's really no single way to use a scraper. But, a few pointers will help you get better results.

**A Slight Bow.** Using a scraper is a two-handed job. The main reason for this is that the flexible scraper works best when forced into a slight bow (lower right drawing). This bowed shape concentrates the scraping action over a smaller area and reduces the effort involved. It also keeps the corners of the scraper from gouging the wood.

**Push or Pull.** Some woodworkers like to "crown" the blade away from their bodies and push it across the wood (middle drawing). Others, myself included, find it easier to pull the scraper (top drawing). This method makes bending the scraper a bit more work, but for me, it's easier to see and control the cut.

**Two Angles.** When you draw a scraper across a workpiece, there are a couple angles to think about. The first is the pitch or cutting angle of the blade (detail 'a' at right). The second is the angle of the long scraper edge in relation to the grain direction. The good news here is that neither angle is critical.

The cutting angle is usually somewhere between 45° to 60° to vertical. But basically, it's whatever angle seems to work best. The burr you form isn't always going to be the same size and shape. So basically, it's just a matter of feel. Fine shavings let you know it's right.

As the drawing shows, the scraper blade is held slightly skewed to the grain direction. This way, the scraper is more likely to hit the high spots and skip over the low spots. To avoid creating ridges, I alternate angling the blade from one side to the other.

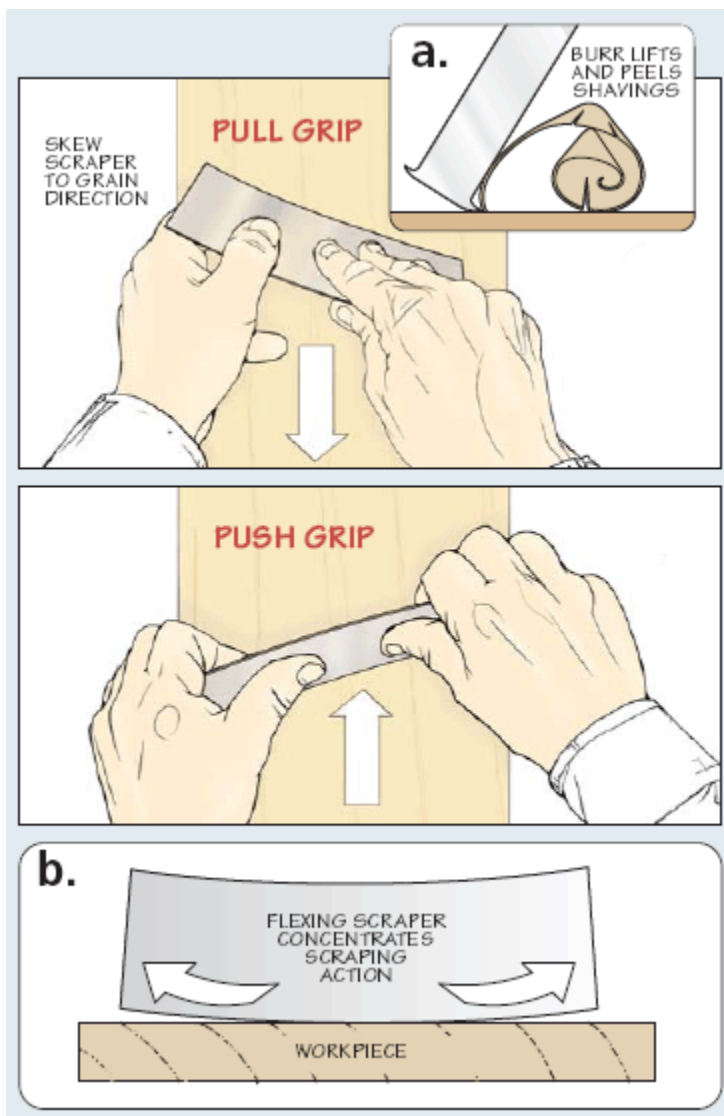

You'll find that the learning curve for success with a scraper is a pretty small hill to climb. And it's definitely worth the effort.

**President**

Bill DeGarmo (316) 773-1912  
[billdegarmo@sbcglobal.net](mailto:billdegarmo@sbcglobal.net)

**Vice President**

Dan Carlyle (316) 794-8405  
[dcarlyle@ucuit.com](mailto:dcarlyle@ucuit.com)

**Secretary**

Mike Hutton (316) 744-3036  
[ictwoodworker@cox.net](mailto:ictwoodworker@cox.net)

**Treasurer**

Wendell Parks (316) 684-7508  
[parksmail@sbcglobal.net](mailto:parksmail@sbcglobal.net)

**Librarian**

Garry Dougherty (316)722-5539

**Toy Chairman**

**Membership Chairman**

Guy Waldo (316) 684-1138  
Bill Tumbleson (316) 835-2036

**Editor: The Knot Hole**

Jerry Keen (316) 722-2735  
[Jerry.keen@cox.net](mailto:Jerry.keen@cox.net)

**Sponsor Chairman**

Dennis Laird  
[dalaird@cox.net](mailto:dalaird@cox.net)

**Area Guilds and Clubs**

**South Kansas Wood-  
turners**

Royce Wallace, President  
601 Wetmore Drive  
Wichita, Kansas 67209-1322  
(316) 722-6749  
[wallburl@att.net](mailto:wallburl@att.net)

**Great Plains Woodcarvers**

Wichita Kansas President Walt  
Kuykendall  
[wkuykendall@msn.com](mailto:wkuykendall@msn.com)  
Meeting: 2<sup>nd</sup> Tuesday of each  
month, dinner at 6:00, meeting  
7:00 at the Hometown Buffet,  
6820 W. Central.  
[sjclarke@juno.com](mailto:sjclarke@juno.com)

**CLASSIFIED  
ADS**



JET Printing and Digital Copies  
6410 E. Central  
Wichita, Kansas 67206  
316-685-2679  
[www.jet-printing.com](http://www.jet-printing.com)

The Sunflower  
Woodworkers' Guild of  
Wichita Kansas publishes the  
Knot Hole newsletter  
monthly. Deadline for articles  
and information is the 2<sup>nd</sup>  
Monday of each month.  
Mailing date is the 3<sup>rd</sup> week  
of each month. Permission to  
reprint original material is  
granted to other  
woodworking groups,  
providing proper credit is  
given. *Articles attributed to  
publications other than the  
Knot Hole Newsletter should  
be used only with permission  
from that particular  
publication.* Send articles,  
photos and information to  
Jerry Keen  
811 Norman  
Wichita, KS 67212  
E-mail [jerry.keen@cox.net](mailto:jerry.keen@cox.net)



**BIG  
TOOL  
STORE**  
4640 E 63<sup>rd</sup> St. South  
Derby, KS 67037  
316-788-6500

Providers of:



And many other fine  
Woodworking tools and supplies  
is proud to be a sponsor of the  
Sunflower Woodworkers Guild.

Timothy Dreiling



exotic & domestic hardwood •  
plywood • veneer • furniture design & fabrication

tel. 316.265.6608  
436 N. Seneca Wichita Ks. 67203

Sunflower Woodworkers Guild membership is voluntary. Our paid dues list will be consolidated after the June meeting, eliminating from that list all those who have not paid their '08 dues. This list determines who gets the Knothole. New and previous members will need to submit new applications when joining.

Newsletter of the Sunflower Woodworkers Guild  
811 Norman  
Wichita, Kansas 67212